

MEDI WAVES



Fetal Monitor

BT-300
BT-350 LED
BT-350 LCD

Fetal Monitor



Advanced Fetal Monitor dedicated to Fetal health monitoring



Wall mount



Carrying bag

Fetal Monitor



BT-350 LCD Graphic mode



BT-350 LED



BT-350 LCD Number mode



USB port for data export

BT-350 LCD

displays trace and numbers. Stored data can be reviewed afterward.

BT-350 LED

displays numbers only. Large and bright LED is visible from a distance.

CTG Analysis*

calculates important data such as baseline, Acceleration, Deceleration, fetal movement.

Various Paper Selection

BT-350 can use two most usual papers in the market (30-240bpm / 50-210bpm)

Cross Channel Verification

prevent the FHR is miscalculated by twin fetus by alarm.

USB Data Save

FHR and UC trend data can be exported to USB memory stick and it can be managed by BCM-350 Central Monitoring Software

Multi Language Support*

13 languages including English, Chinese, Spanish, German, Russian, Portuguese and more languages are available.

Central Monitoring Software

Works on BCM-350 software along with other Fetal monitors by wire or wireless.

Built-in Quick Guide*

Quick guide in the menu screen helps the user get to understand how to use and maintain the monitor properly.

*BT-350 LCD only

Fetal Monitor



BT-300

Portability

Compact design with built-in handle enable portable use especially to midwives.

Zoom-in Function

Enlarge FHR graph scale on the paper to examine the trend with more dynamics by focusing FHR range to most frequent area.

Rechargeable Battery*

Li-ion battery enable BT-300 can operate without AC power up to 3 hours.

Offset DOP2 FHR

This function makes DOP2 FHR 20 bpm higher to enhance DOP2 trend easy to read.

Waterproof probe

All probes are waterproof and ready for water birth (IPX8).

Acoustic Stimulator*

Stimulate sleeping fetus to speed up the test or to facilitate further evaluation of non-stress test (NST).



*Option

Central Monitoring Software



Connection

Maximum connection: 16 monitors

Wire connection : RS-232C, LAN*

Wireless connection : Bluetooth (optional) *BT-350 only



Remote Control

BCM-350 is not only monitoring Fetal Monitors at central station but it can control monitors remote for basic function.

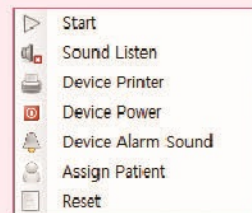

Database

BCM-350 is store data from the BT-300/350 by network connection and by USB memory. Stored data in internal memory of BT-350 can be exported to USB memory and it can be managed by BCM-350



Multi-language Support

BCM-350 is multi-lingual software and friendly to many non-English speaking users.

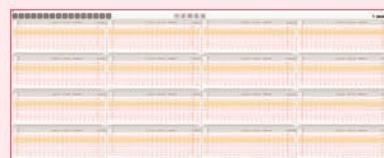

Various Bed Display mode

Various style of Bed display can satisfy every users with their own preference.



Fetal Monitors Technical Specification

Model	BT - 300		BT - 350	
Order code	300	350E	350L	
Dual DOP Probe	●	●	●	
FHR Range (BPM)	30 ~ 240	30 ~ 240 / 50 ~ 210	30 ~ 240 / 50 ~ 210	
DOP2 Offset (20BPM)	●	●	●	
Auto FM Detection	●	●	● 	
FM Graph Print	●	●	●	
DOP Signal Quality Indicator	●	●	●	
UC Probe	External type			
UC Range	0 - 99	0 - 99	0 - 99	
Waterproof Probe (IPX8)	●	●	●	
Display Type	LED	Large LED	7" Color LCD	
Wall Mount		○	○	
Trend Display			●	
Trend Data Save			450 Hours 	
Alarm Sound Level		2 levels	2 levels	
Alarm Sound	Tachycardia, Bradycardia			
Information Sound	Probe Disconnection, Printer door open, No Paper, Low Battery			
Printer Speed	1, 2, 3cm/minute, 10cm/min(Trend mode only)			
Thermal Paper (Z-fold)	130mm(W) x 20.5m(L)	150mm(W) x 13.5m(L)	150mm(W) x 13.5m(L)	
Auto Print	10, 20, 30, 40, 50, 60minute			

● Standard ○ Option

Model	BT - 300		BT - 350	
Order code	300	350E	350L	
Paper Select (30-240/50-210)		●	●	
Patient ID/Name Print			●	
Cross Channel Verification		●	●	
CTG Interpretation			●	
Data Save to USB Memory		●	●	
Multi Langage Support			●	
On-Screen Quick Guide			●	
PC Interface	RS-232C	RS-232C / Ethernet	RS-232C / Ethernet	
BCM-350 CMS	●	●	●	
Power	AC100-240V (50/60Hz) DC18V/2.5A			
Weight (Kg)	5	2.8	2.8	
Dimensions (HxWxD) - mm	190 x 190 x 200	240 x 405 x 360	240 x 405 x 360	
Carrying Bag		○	○	
Rechargeable Battery	○	○	○	
Battery Life (h)	3	5	5 	
Acoustic Stimulator	○	○	○ 	
Cart	○	○	○	
External Bluetooth Connector	○	○	○	
Warranty (Main unit)	2 year	2 year	2 year	



MEDI WAVES INC.

ISO 9001:2015 CERTIFIED

WHO-GMP CERTIFIED | ISO 14001:2004 CERTIFIED | OHSAS 18001:2007

ISO 13485 : 2016 CERTIFIED | CE CERTIFIED

H.O. : B-68, G.T. Karnal Road, Industrial Area, Delhi-110033 (India)

**Works : Plot No. 92, Sector-57, Phase IV, HSIIDC Kundli,
Sonepat, Haryana-131001 (India) Ph. :0130-6542024**

Helpline No. : 011-42384365

E-mail : sales@medi-waves.com | anandmedical@gmail.com

Website : www.medi-waves.com